

Crane

INSTRUCTION MANUAL

1 GALLON/ 4 LITER WARM MIST HUMIDIFIER

MODEL# EE- 5200 W / B



PLEASE READ AND SAVE ALL INSTRUCTIONS TO ENSURE THE SAFE AND EFFECTIVE USE OF THIS APPLIANCE.

TABLE OF CONTENTS

Table of Contents	P.1
Important Safety Instructions	P. 2
General Safety Instructions	P.3
List of Main Parts, Tech. Specifications, Contents of Packaging	P.4
Before First Use	P.5
Operation and Use	P.5-6
Maintenance	P.7-8
Trouble Shooting	P.9
Service Center Information	P.9
Warranty Information	P.10
Warranty Card	P.12



IMPORTANT SAFETY INSTRUCTIONS

WARNING! READ AND SAVE THESE INSTRUCTIONS. Failure to follow all the instructions listed below may result in electric shock, fire and/or serious personal injury.

1. DO NOT carry water tank by handle when it is filled with water. It is advisable to carry filled water tank with two hands.
2. DO NOT operate outdoors; this humidifier is intended for indoor use only.
3. DO NOT touch the steam vapor. Steam can cause burns.
4. DO NOT remove the water tank during operation or within 15 minutes after the humidifier is turned off and unplugged. Serious injury may result.
5. DO NOT operate without water. Always have water in the water tank when operating the unit.
6. Use only clean, cool tap water to fill the tank. DO NOT use hot water.
7. DO NOT pour water in any openings than the water tank.
8. Be sure that the water tank cap is firmly tightened. DO NOT aim mist directly at children, walls or furniture, and electrical appliances.
9. Use only a 110-120VAC outlet. ALWAYS plug and unplug unit with dry hands.
10. Never operate the unit with a damaged cord or plug.
11. Always place the unit on a smooth, lint free, non-metallic, waterproof, level surface, and away from direct sunlight. Keep the cord away from heated surfaces and areas where it could be walked on or tripped over. Unplug the unit when not in use and whenever you clean or move the unit.
12. DO NOT add medication of any type into the mist cup, base or water tank. Do not cover any openings on the unit or insert objects into any openings.
13. The unit should not be left unattended in a closed room as the air could become saturated and leave condensation on walls or furniture. Leave room door partly open.
14. The humidifier requires daily and weekly cleaning to operate appropriately. Refer to cleaning instructions.
15. NEVER use detergents, gasoline, glass cleaner, furniture polish, paint thinner or other household solvents to clean any part of the humidifier.
16. Do not tilt or tip the unit or attempt to empty or fill it while it is in operation.

SAVE THESE INSTRUCTIONS!

GENERAL SAFETY INSTRUCTIONS



WARNING! Read and understand all instructions. Failure to follow all instructions listed below may result in electric shock, fire or serious personal injury. The warnings, cautions, and instruction discussed in this instruction manual cannot cover all possible conditions and situations that may occur. It must be understood by the operator that common sense and caution are a factor which cannot be built into this product, but must be supplied by the operator.

THIS HUMIDIFIER IS NOT A TOY!

Do not let your child play with this appliance. Serious injury and electrocution might be possible. This appliance has to be operated by an adult only. Children should be supervised to ensure that they do not play with the humidifier.

SAVE ALL INSTRUCTIONS!

CAUTION: A short power supply cord is provided to reduce the risk of personal injury resulting from becoming entangled in or tripping over a longer cord. Extension cords are available from local hardware stores and may be used if care is exercised in their use. If an extension cord is required, special care and caution is necessary. Also the cord must be: (1) marked with an electrical rating of 125 V and at least 13 A., 1625 W., and (2) the cord must be arranged so that it will not drape over the countertop or tabletop where it can be pulled on by children or tripped over accidentally.

ELECTRIC POWER

If electric circuit is overloaded with other appliances, your appliances may not operate properly. The appliances should be operated on a separate electrical circuit from other operating appliances.

POLARIZED PLUG

This appliance has a polarized plug (one blade is wider than the other). As a safety feature to reduce the risk of electrical shock, this plug is intended to fit in a polarized outlet only one way. If the plug does not fit fully in the outlet, reverse the plug. If it still does not fit, contact a qualified electrician. Do not attempt to defeat this safety feature.



SAFETY WARNING

Although your appliance is easy to operate, for your safety, the below warnings must be followed:

1. Do not place the appliance near a heat source.
2. Never leave the appliance unattended while connected to the electrical outlet.
3. To avoid any accidents, never put a hand over a mist and never cover it when the appliance is in operation.
4. Use the appliance on a stable surface away from water.
5. Do not unplug from the wall socket by pulling on the supply cord.
6. The appliance must be unplugged:
 - A. Before either filling or emptying
 - B. Before any cleaning or maintenance
 - C. After use
 - D. If it appears to be faulty

THIS PRODUCT IS INTENDED FOR HOUSEHOLD USE ONLY.

LIST OF MAIN PARTS

1. Medicine Cup
2. Mist Channel
3. Base
4. On/Off Switch
5. Mist Chamber
6. Water Tank Cap
7. Water Tank
8. Handle

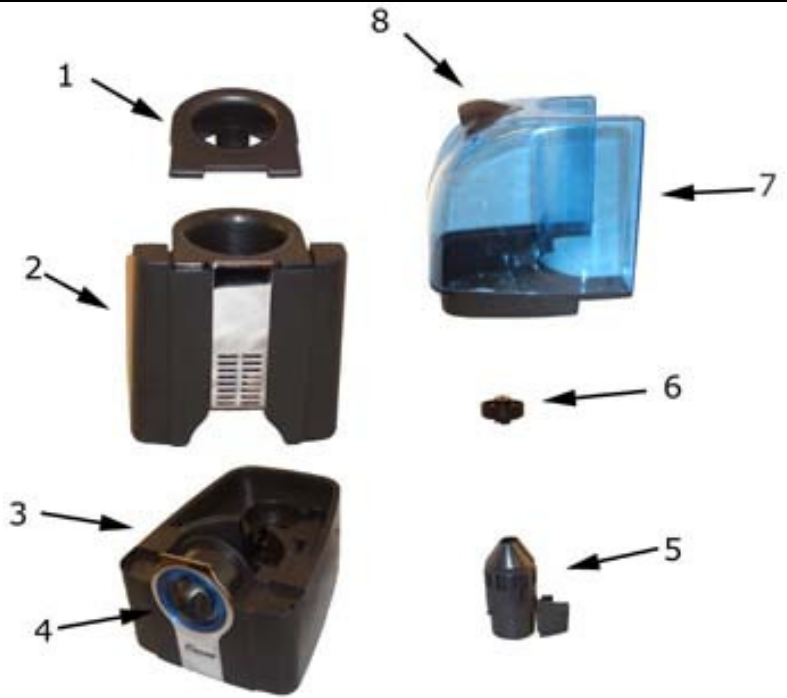

Fig. 1

TECHNICAL SPECIFICATIONS:

Rating Voltage	120V
Frequency	60Hz
Power	400W
Water Tank Capacity	Approx. 1.1 Gallon / 4.2 Liter
Output Per 24 Hours	Approx. 3.6 Gallon / 13.7 Liter
Run Time Per Tank	Min. 7 Hours
Humidifying Capacity	Up to 250 sq.ft. / 23 m ²

CONTENTS OF PACKAGING

NOTE: The humidifier is pre-assembled and ready to use.

- a. Instruction Manual
- b. Humidifier Base
- c. Water Tank
- d. Mist Channel
- e. Mist Chamber
- f. Medicine Cup

If any of the above items are missing, please contact our service department at 1-888-599-0992 (<http://www.crane-usa.com>) for replacement. Business hours Mon-Fri 9:00am - 4:00pm CT

BEFORE FIRST USE

CHECK HUMIDIFIER PLACEMENT - Place the Humidifier on non-metallic, lint free, waterproof, level surface for best performance. This is to help disperse the mist in the air, and prevent it from being knocked or tipped over.

CHECK WATER LEVEL SENSOR - Make sure that the water level sensor is secured properly. Refer to "cleaning and maintaining water level sensor" on page 9 for instructions on how to clean water level sensor.

CAUTION:

DO NOT operate the humidifier without water in the water tank.

DO NOT plug in the cord with wet hands; electric shock could happen

1. Be sure the humidifier is switched to OFF and the unit is disconnected from electrical outlet.
2. Select a location for your humidifier. On a flat surface, about 4 inches away from a wall.
3. DO NOT place the humidifier on a finished floor or near furniture, which can be damaged by moisture or water. Place on a water resistant surface.
4. DO NOT place Humidifier on top of a towel, or a carpeted surface. The air vent on the bottom may become blocked, and overheat the humidifier.

OPERATION AND USE

1. Lift the water tank off the humidifier base.
2. Turn over the water tank and unscrew the water tank cap at the bottom of the tank by turning it counterclockwise.
(See Fig. 6)



Fig. 6

3. Fill water tank with cold water; do not fill all the way to the rim. **DO NOT CARRY FULL WATER TANK BY HANDLE.** ALWAYS HOLD FULL WATER TANK WITH TWO HANDS ON EITHER SIDE OF WATER TANK.
(See Fig. 7)



Fig. 7

DO NOT use hot water. Use cool tap water.

DO NOT add any medication to the water

DO NOT pour water into Mist Channel.

DO NOT overfill medicine cup and allow medicine to spill into mist chamber.

4. Replace the water tank cap, aligning the threads on the tank with the threads on the cap, and turn it clockwise (*See Fig. 8*).

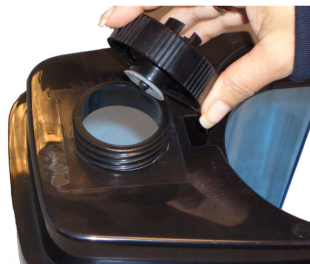

Fig. 8

5. Turn the tank over, holding one hand by the top handle and another hand under tank. Place full water tank on the central body, making sure it fits perfectly. Place mist cup on top of the mist channel.
6. Plug the power cord into a wall socket and turn on the unit. The On/Off switch is located at the central body.
7. The Power Light will turn blue.
8. Use the power switch to adjust the intensity of the mist output. Turning the switch clockwise will increase the moisture output, turning the switch counterclockwise will reduce the moisture output (*see Fig. 9*).



Fig. 9

9. When the humidifier runs out of water the blue power light will turn off, and the mist output will stop. This safety feature uses a water level sensor to stop the nebulizer once the water level sinks below the required level in the water basin. A small orange light will appear to indicate that the humidifier has automatically turned off. Turn the humidifier off and unplug before removing and refilling the water tank.

HOW TO USE MEDICINE CUP

The medicine cup allows the addition of medications recommended for use with warm mist humidifiers only.

1. Remove the medicine cup from top of mist chamber for easier filling.
2. BE CAREFUL not to overfill the medicine cup. Overfilling may cause medicine to spill into mist chamber. Medicine in the mist chamber may affect the operation of the humidifier.
3. Place medicine cup on top of the mist chamber.



A NOTE ABOUT HUMIDITY

- It is best to keep the humidity level at about 30-50 percent of relative humidity.
- The comfort level of humidity will vary from room to room and with changing room conditions.
- In cold weather, windows and even some walls may fog or develop frost from excessive indoor humidity. If this occurs, reduce the mist intensity setting to avoid damage from condensed water dripping on windowsills.
- Too much humidity in the room may allow moisture to accumulate on surfaces where bacteria and fungi can grow. Moisture that gathers may also damage furniture and walls, especially wallpaper.
- To eliminate excessive humidity, especially in small rooms, leave the room door open and adjust the mist intensity control setting.

MAINTENANCE

IMPORTANT: Failure to keep this humidifier clean from mineral deposits normally contained in any water supply will affect the efficiency of the operation. Customer failure to follow these instructions may void warranty



CAUTION:

Always be sure that the appliance is unplugged and switched OFF before cleaning or attempting to store the item. NEVER PLUG OR UNPLUG UNIT WITH WET HANDS.

DO NOT leave water in water tank or water basin when unit is not in use as it may result in the build up of mineral deposits and bacteria that can inhibit the output efficiency of the humidifier. If water remains in the water tank for more than a day or two, bacterial growth is possible.

CARE AND CLEANING

Portable humidifiers require regular cleaning in order to reduce the risk of bacterial growth, and to remove any scale residue to maintain good operational performance. Cleaning is not too difficult. Follow the procedures below for healthy maintenance of your warm mist humidifier.

Daily Maintenance

1. Turn switch to off (O) and unplug from wall outlet.
2. Be sure the unit has cooled for at least 15 minutes, then lift the water tank from base and place in sink or tub.
3. Carry the humidifier base to the sink and drain any remaining water. Wipe clean and dry with a clean cloth.
4. Drain water from water tank. Wipe clean, and dry with a clean cloth.

Weekly Maintenance (Removing Scale)

NOTE: We recommend cleaning the humidifier weekly, more often if you have hard water or notice a build-up of impurities or detect unpleasant odors.

Repeat Steps 1-4 Above

How to Clean Water Tank

1. Fill water tank with ½ water and ½ tablespoon of bleach.
2. Let stand twenty minutes, shaking vigorously with two hands every few minutes.
3. Carefully empty the tank after 20 minutes, and rinse with warm water until you can no longer detect a bleach smell.

How to Clean Heating Element

1. Fill the heating element with undiluted white vinegar.
2. Let stand for 20 minutes. Dampen soft, clean cloth or sponge with undiluted white vinegar and wipe out heating element to remove scale. DO NOT use soap, detergents or abrasive cleaners.
3. Rinse heating element using clean warm water, being careful not to submerge the base in the water. Dry thoroughly. DO NOT IMMERSE WATER BASIN IN WATER.
4. Soak the removable mist chamber in a solution of ½ white vinegar and ½ water for 20 minutes. Rinse thoroughly and then wipe dry with a soft clean cloth.

How to Clean Humidifier Exteriors

1. DO NOT IMMERSE THE BASE IN WATER OR ANY OTHER LIQUID an electric shock may result or the humidifier may be damaged.
2. Wipe all exterior surfaces of the base with a soft, dry cloth.

End of Season Maintenance

1. Follow above weekly cleaning procedure at the end of the humidification season, or when the humidifier will not be used for several days, being sure to dry all parts. Allow the water tank to thoroughly dry before storage. DO NOT store with water inside any part of the humidifier.
2. Save original box for easy storage.
3. Leave tank cap partially loosed during storage to prevent tank cap and gasket from sticking together. This will prolong the life of the gasket.
4. Store humidifier in a cool dry location.

Cleaning Water Level Sensor

To clean the water level sensor unscrew (*see Fig.11*) the plastic cap on the pin by pulling it up (*see Fig.12*). Remove the water sensor and cap and clean by wiping the parts with a soft damp cloth. Replace the parts by first putting the water sensor onto the pin and then pressing the plastic cap on the end of the pin to secure the sensor. Do not use excessive force.



Fig. 11



Fig. 12

TROUBLE SHOOTING

CAUTION: DO NOT attempt to repair the motor or nebulizer yourself. If the humidifier continues to not operate please call our service center (see toll free number below).

Problem	Solution
<i>Humidifier Light is staying orange and not turning blue</i>	<ul style="list-style-type: none"> ▪ Ensure that water level float is assembled properly. ▪ Clean water float and re-assemble.
<i>If humidifier does not work at all:</i>	<ul style="list-style-type: none"> ▪ Ensure it is properly plugged into a power outlet. ▪ Check that the switch is in the ON position. ▪ If Power On Blue light does not come on, bring to authorized service station.
<i>If there is a strange odor:</i>	<ul style="list-style-type: none"> ▪ Clean the tank with water and white vinegar or bleach water solution and rinse with clean water. ▪ Leave the tank open for some time without the cap, in a cool place.
<i>The power light is blue but there is little or no mist being emitted:</i>	<ul style="list-style-type: none"> ▪ Check that there is water in the tank. ▪ Check for possible lime deposits on the water level sensor or the heating element. ▪ Make sure that nothing blocks the mist output. ▪ Check that the air vent on bottom of humidifier is not blocked. ▪

SERVICE CENTER

If you have any question in regards to the operation of this appliance or are in need of a spare part please contact our service center at:

Crane USA Inc.

Tel: 1-888-599-0992 (Business Hours Mon-Fri 9:00am-4:00 pm Ct)

Website: <http://www.crane-usa.com>

1800 Nicholas Blvd

Elk Gove Village, Illinois 60007

ENVIRONMENTAL PROTECTION

If the appliance should no longer work at all, please make sure that it is disposed in an environmentally friendly way, by handing it into a public collection point. Please do not put it with your household waste.



LIMITED WARRANTY

Thank you for purchasing a top quality **Crane** product. This Warm Mist Humidifier was tested and meets our stringent quality standards. This product is warranted to be free from manufacturing defects under normal use and conditions for 1 year.

In case you find this product to have a manufacturing defect please proceed as follows:

- A. Within 90 days of purchase: return the product to your retailer for a replacement or a refund.
- B. After 90 days and within the warranty period: send the product and all of it's accessories to our service center. The consumer will be responsible for all shipping costs to the Crane Service Center. Crane will not assume responsibility for loss or damages to the product being returned to us. To avoid transport damages carefully package the product and insure it with the carrier. Be sure to fill out the warranty card and include it with a copy of the dated sales receipt. In return you will receive your repaired item, or a new product at the service center's discretion.

WARRANTY IS ONLY VALID WITH A DATED PROOF OF PURCHASE.

The warranty is void if the defect is due to accidental damage, misuse, abuse, neglect, improper repair or alteration by unauthorized persons or failure to follow operation instructions provided with the product. This warranty does not apply to normal wear and tear, as well as commercial use.

The warranty is non-transferable and applies only to the original purchase and does not extend to subsequent owners of the product. Liability under this warranty is limited to repair, or replacement. In no event shall liability exceed the purchase price paid by the purchaser of the product. Under no circumstances shall there be liability for any loss, direct, indirect, incidental, special or consequential damage arising out of in connection with use of this product.

This warranty is only valid in the 48 contiguous states plus the District of Columbia. Excluding Alaska, Hawaii, Puerto Rico, and the Virgin Islands. This warranty is effective only if the product is purchase and operated in the United States of America.

This Warranty gives you specific legal rights. However you may have other rights that vary from state to state. Some states do not allow limitation on implied warranties or exclusion of consequential damages therefore these restrictions may not apply to you.

Any instruction or warranty included in this manual may be subject to change without notice. For the most up to date set of instructions and warranty please contact us or visit our web site.

Crane USA Inc.

Tel: 1-888-599-0992 (Business Hours Mon-Fri 9:00am-4:00 pm CT)

Website: <http://www.crane-usa.com>

1800 Nicholas Blvd

Elk Grove Village, Illinois 60007

WARRANTY CARD



Warm Mist Humidifier

In case you find this product to be defective please proceed as follows:

- A. Within 90 days of purchase: return the product to your retailer for a replacement or a refund.
- B. After 90 days and within the warranty period: send the product and all of it's accessories to our service center. The consumer will be responsible for all shipping costs to the Crane Service Center. Crane will not assume responsibility for loss or damages to the product being returned to us. To avoid transport damages carefully package the product and insure it with the carrier. Be sure to fill out the warranty card and include it with a copy of the dated sales receipt. In return you will receive your repaired item, or a new product at the service center's discretion.

This Warm Mist Humidifier was tested and meets our stringent quality standards. This product is warranted to be free from manufacturing defects in original materials, including original parts, and workmanship for 1 year with proof of purchase.

Please print clearly and fill in your details below. Send it together with the product and purchase receipt. Please read the Limited Warranty conditions mentioned in this instruction manual.

Customer Name	
Street	
City	
State	
ZIP Code	
Phone #	
Model #/Style	
Purchase Date	
Description of Defect :	

Service Center Address:

Crane USA Inc.

1800 Nicholas Blvd Elk Grove Village, Illinois 60007

Tel: 1-888-599-0992 (Business Hours Mon-Fri 9:00am-4:00 pm

CT)Website: <http://www.crane-usa.com>

PLEASE DETACH THIS SECTION AND RETURN IT WITH YOUR PRODUCT

WARRANTY CARD

